



UtahStateUniversity

Edith Bowen Parent Parking

PARENT PERMIT HOLDERS

PARENT permit holders may park in Blue designated areas, Tennis Pay & Display, or Yellow areas

PARENTS WITHOUT PERMIT

May park in the designated Parking Meters or Paid Parking Lots. The following rates apply

PAID LOTS \$1.50 per hour
\$.75 per half hour

PARKING METERS \$.05 = 4 mins
\$.10 = 8 mins \$.25 = 20 mins

USU Parking & Transportation Services
USU Police

2012-13

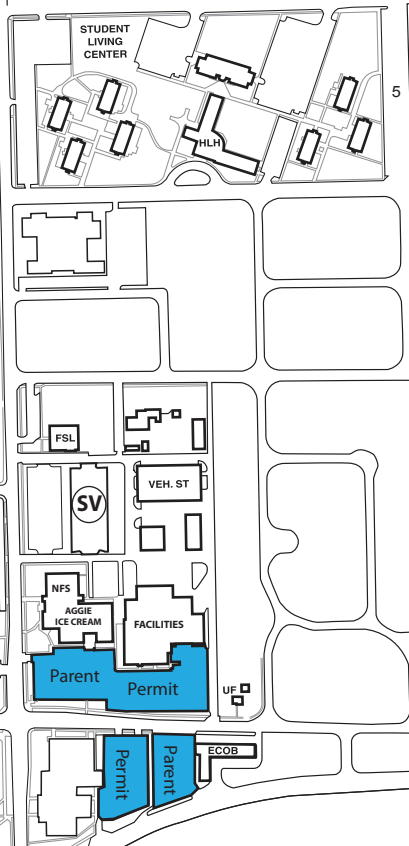
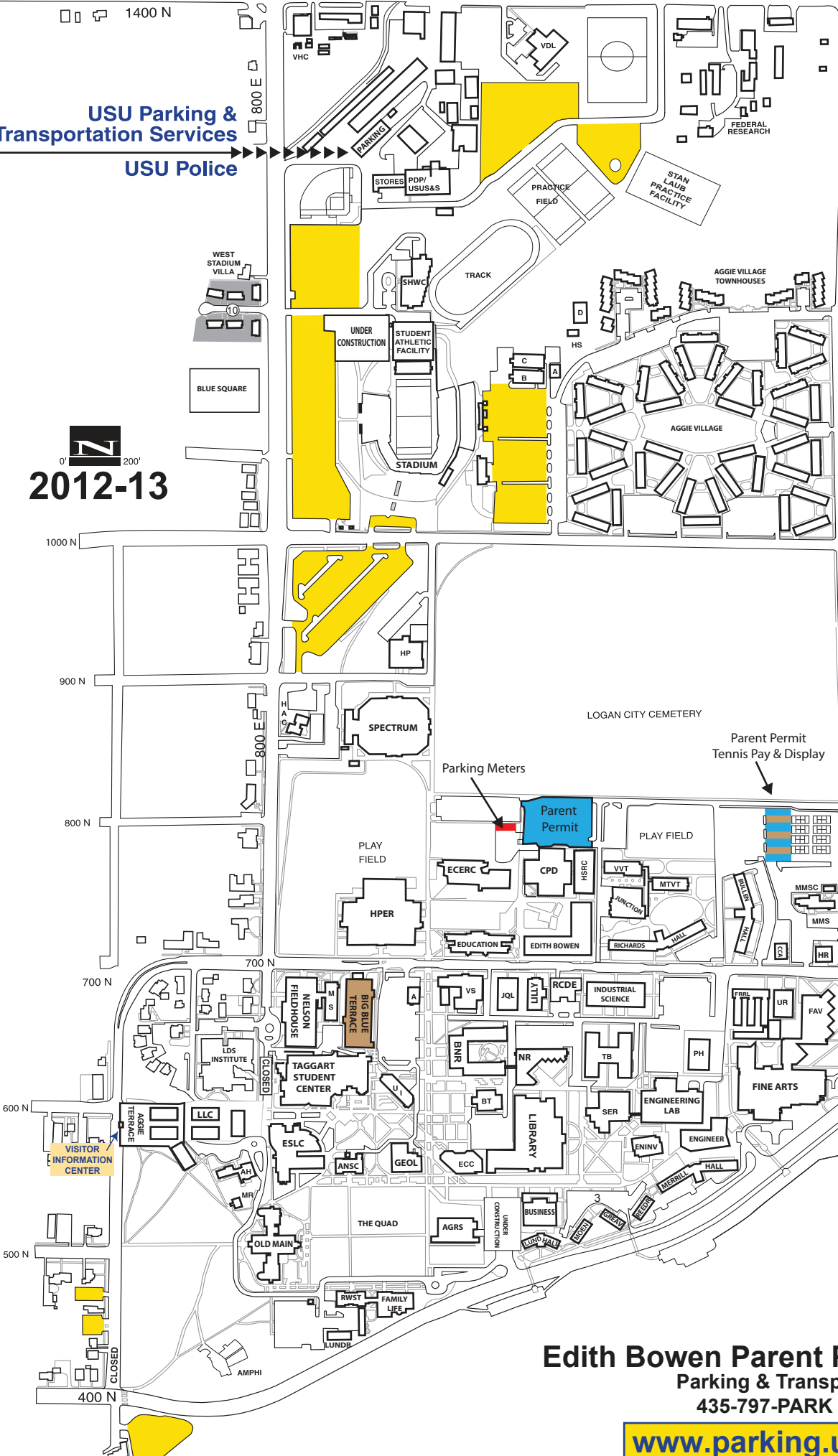

Edith Bowen Parent Parking Areas
Parking & Transportation
435-797-PARK (7275)

www.parking.usu.edu